

Assemble the front half, using the connector.

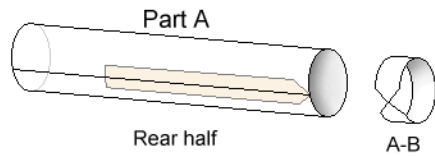

Assemble the rear half, using the connector.

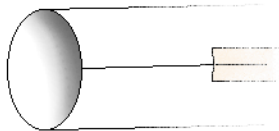

The connector doesn't go all the way back.

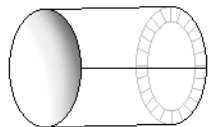

Assemble Part A2. Curl and fold into shape.
This part has no connector.

If Part A2-opt is needed, do not glue it into place until A2 has been glued into place.

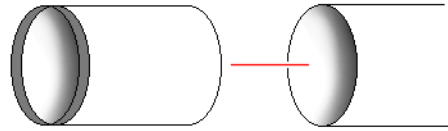

Do not forget to make rims of Part A2 (and A2-opt) black on both sides with a permanent marker.

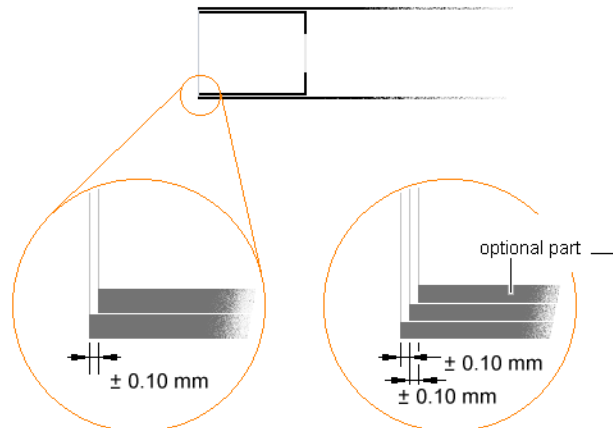

If you are printing on heavy weight paper.

If you are printing on medium weight paper.

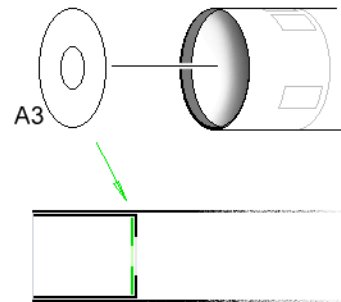

Wait until all previously glued parts have dried, then glue A3.

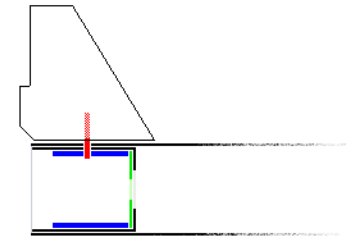

This is how the 3 tail fins should be glued.
We will do this later.

Blue: An extra piece of paper, cardboard or heavy paper, is highly recommended.
Glue into place as shown.

This will make the wings stay firmly in place.

black on the inside

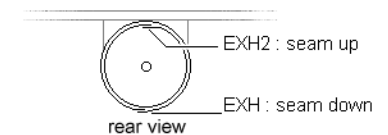
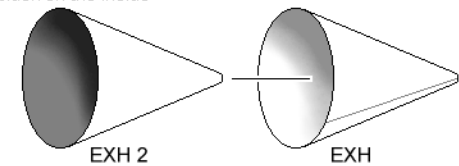

Instructions for building the *Pegasus* model.

Page 2/7

Standard version.

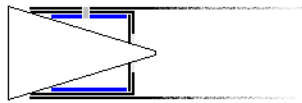
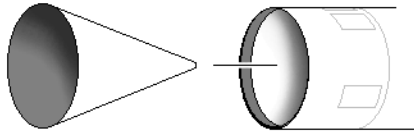

Glue exhaust into place. Don't push it in too hard. A thin, black rim just inside the body must remain visible.

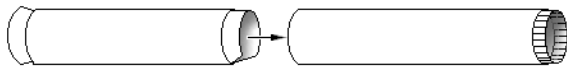

Glue Part A to Part B.

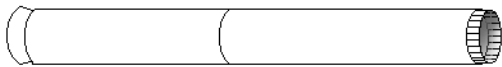

Don't forget: all seams are on the underside and should line up, from rear to front.

Cut out all the parts for the wing and glue them as shown.
Begin with numbers 1, glue them back to back, keep the ink on the outside ! Now glue all 4 parts on one side and let dry well.
Turn assembly over and glue the other parts 2..3..4.

! Important ! Work very accurately !! Cut and glue these parts with care.

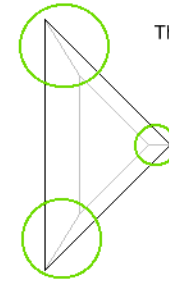
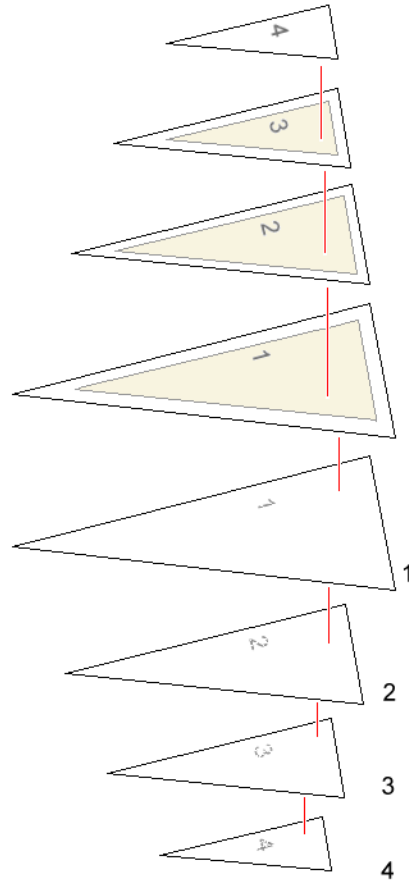

There are 6 very thin triangles to be cut out.
It's better to cut them too small and then widen them with dry waterproof sandpaper.

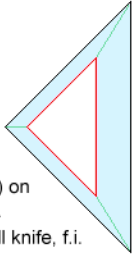

Score these lines (red) on both halves of the wing.
Don't cut the lines, but use a very dull knife, f.i.
Then fold the large parts (blue) down just slightly.
Do this 2 times: for the upper and lower part.

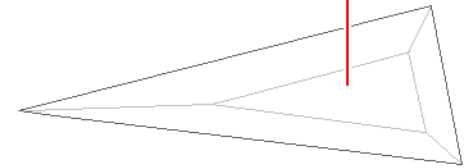
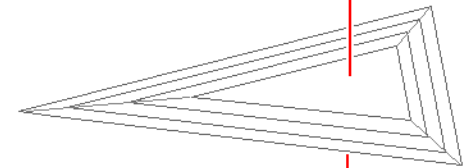
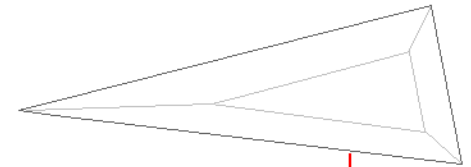

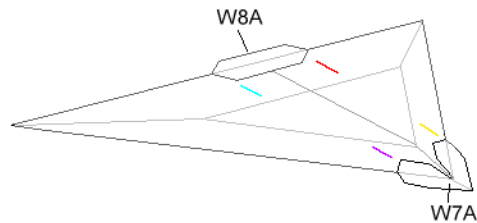
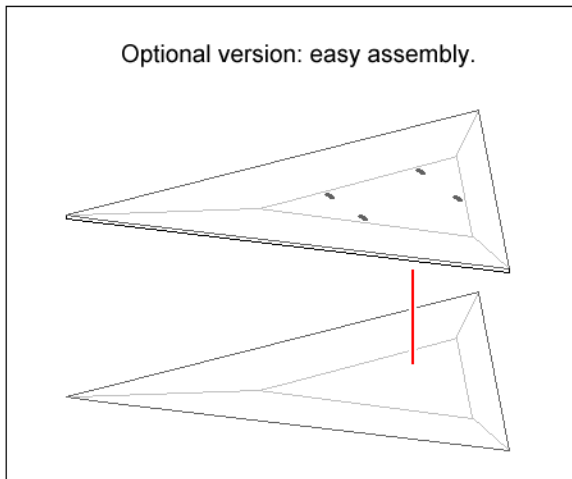

Glue W8A and W7A into place. Use the small grey dots for alignment. Let dry well before glueing next part.

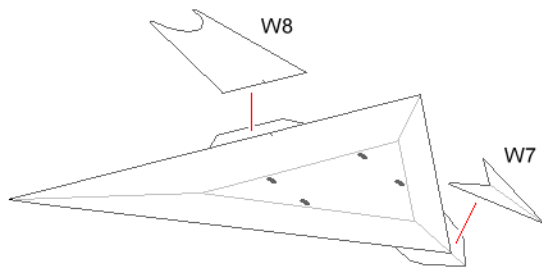

Fold W7 to match the wing.

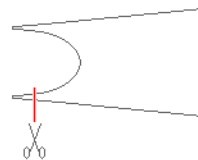
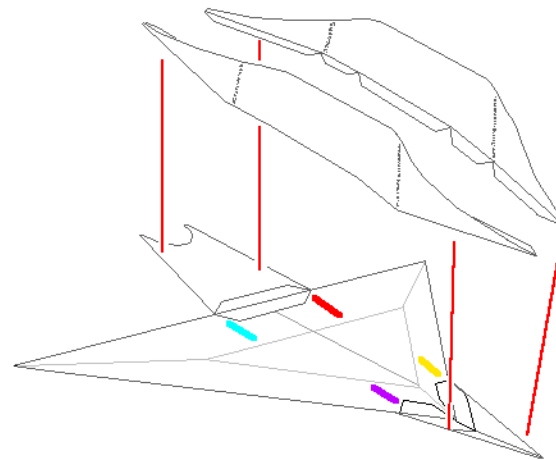

After assembly, cut off one corner (light grey).
But first let the glue dry well.

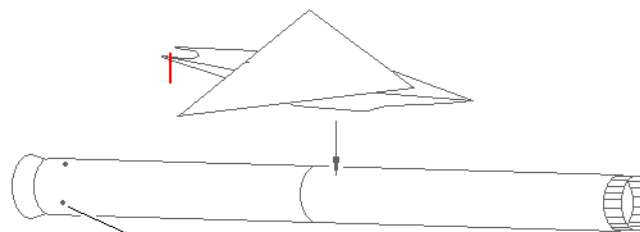

First, drill the 3 holes,
then glue the wing.

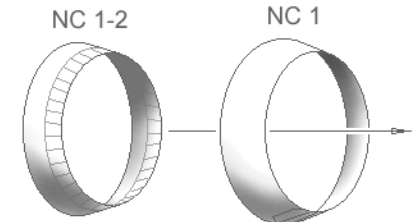

First, assemble NC 1, glue connector inside.
Then glue NC 1-2 inside NC 1.

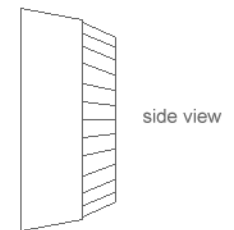

side view

There are 2 versions for the nose cone :
a simple one and a more difficult one.
The last one will, ofcourse, be a bit more realistic.

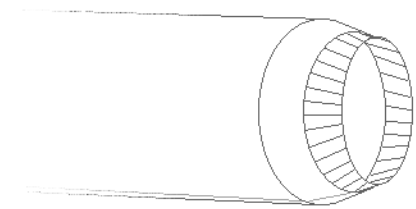

Glue NC 1

Instructions for building the *Pegasus* model.

There are 2 types of nose cones to choose from: a simple one and a more difficult but more realistic one.

Choose any one you like.

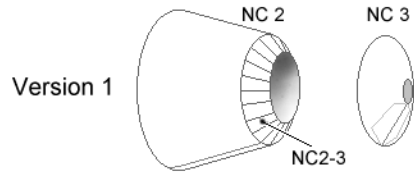

Version 1

If NC 3 doesn't fit well, try to build part NC 3A. That one is slightly bigger.

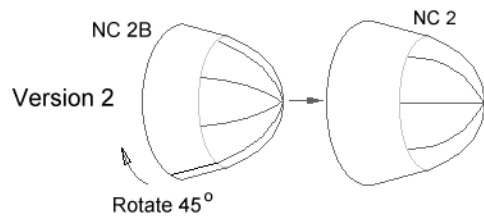

Version 2

Rotate 45°

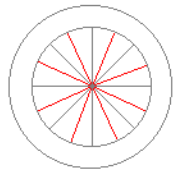

On the inside of the nose cone, each triangle of part NC 2B should touch 2 triangles of part NC 2.

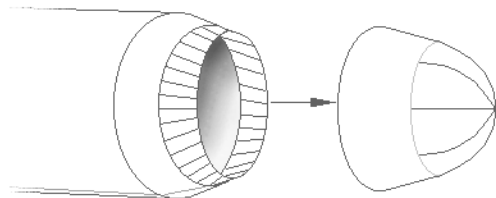

Glue the nose cone into place.

Cut and assemble the fins very accurately.

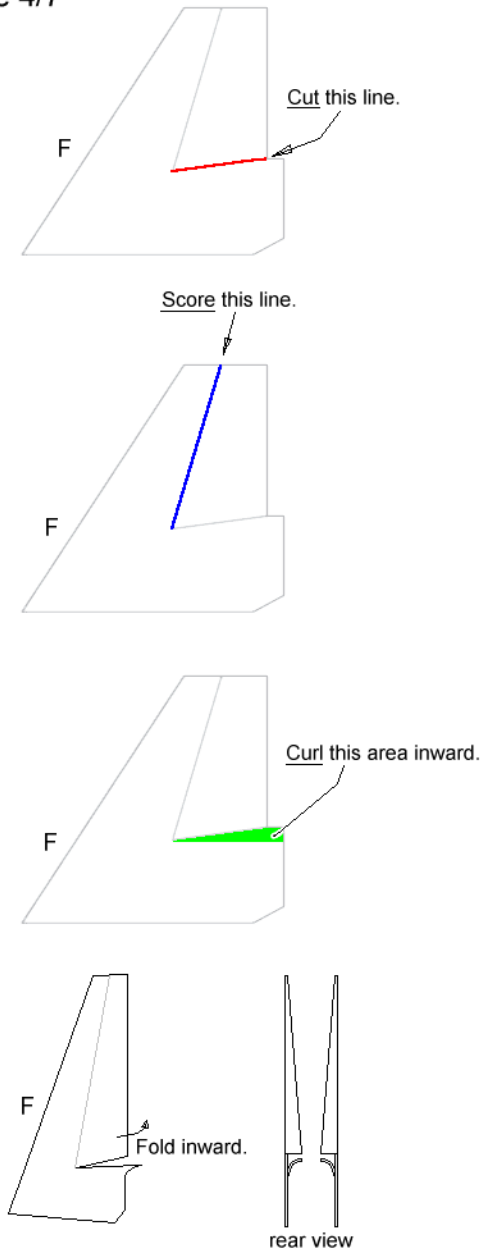
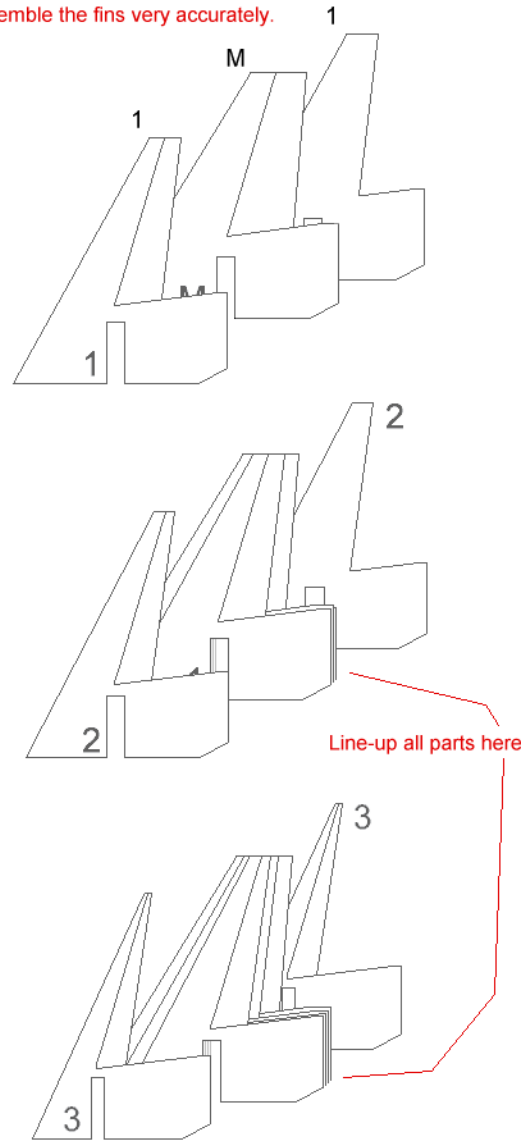

Make 3 tail fins.

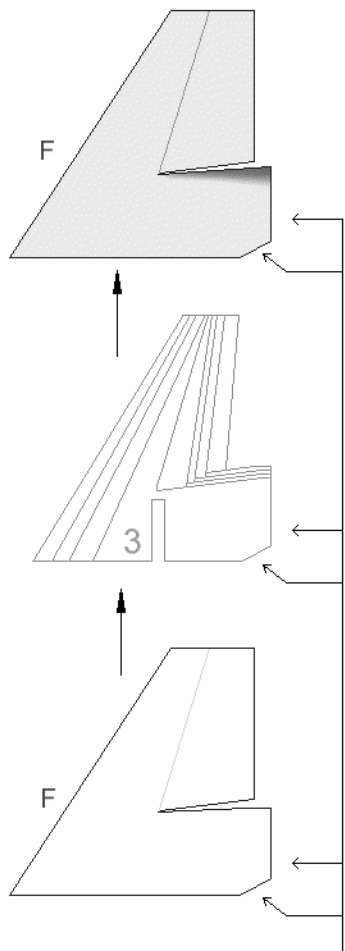

These areas should line-up when assembled.

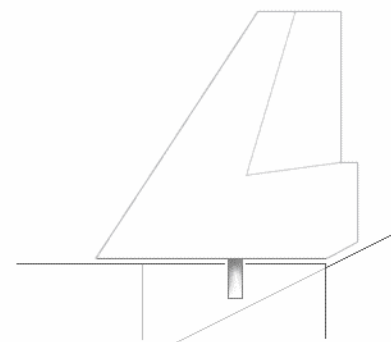
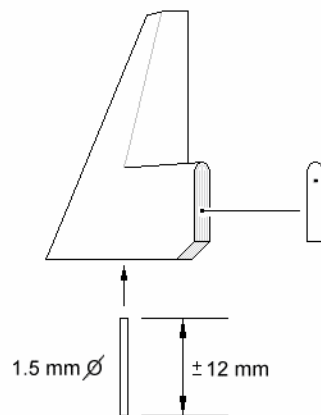
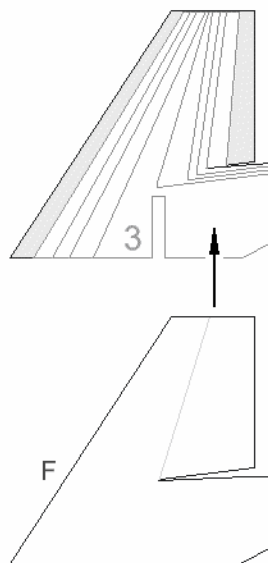

All 3 fins must be glued about 0.5 mm above the hull.



Fin spacer

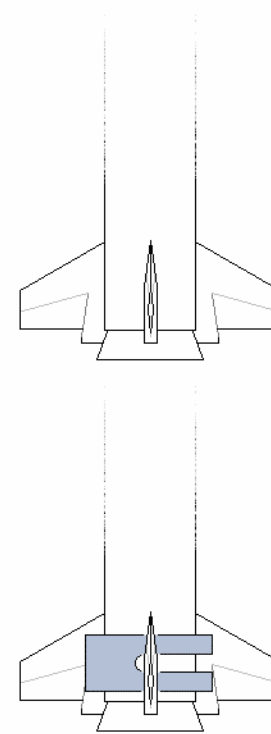

Keep the spacer in place until the glue has dried.

(Do not accidentally glue the spacer to the model.....!)

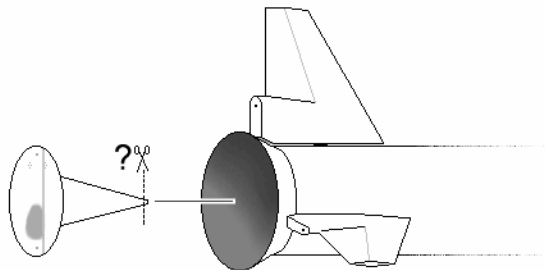
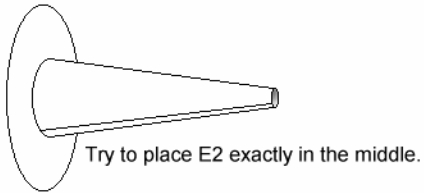
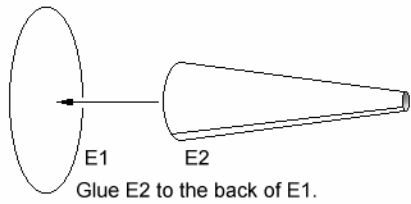

If E1 doesn't fit well into the exhaust nozzle, cut off a very small piece of the tip of E2 until it all fits nicely.

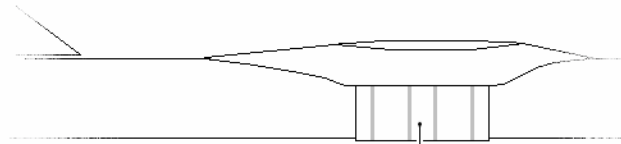
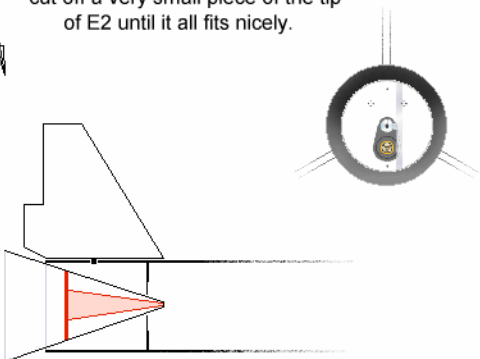

Glue part G.
First fit dry and cut to length !!

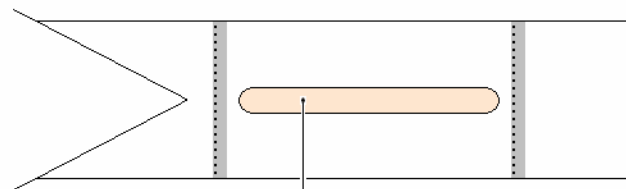
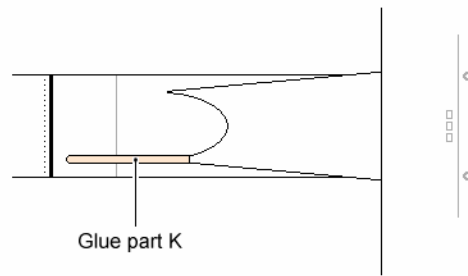

Glue part H



Optional: add Part I, two on both sides.

Use same part from sheet number 8 if a thinner part is required (sheet 8 is printed on thinner paper than the other sheets.)

Make Part I rounded, don't glue it flat !

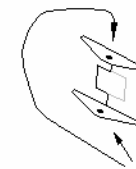
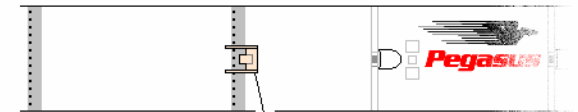

Fold and glue part J.
One on each side.

Paint a small black dot with a fine-tip marker, 2 dots per part.



Optional, for extra detail.

Use part L for easy assembly.

Use part L2 for a more realistic appearance.

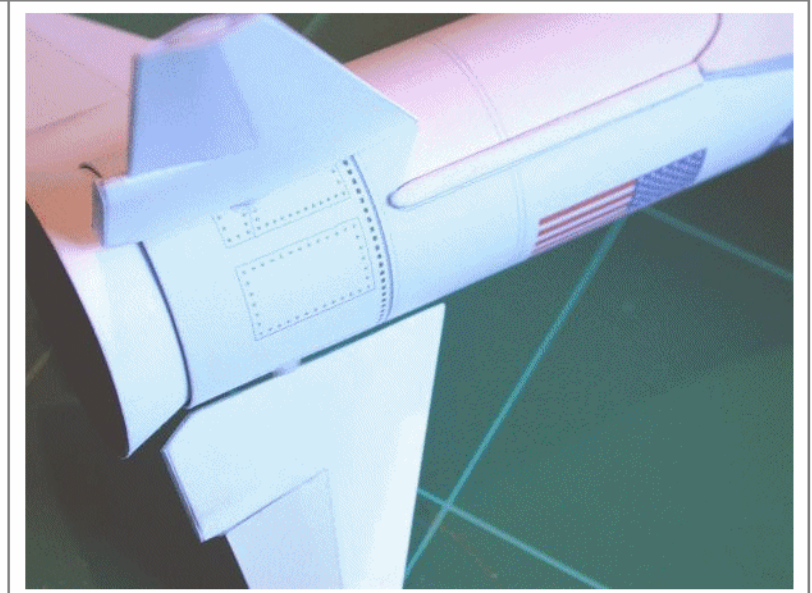
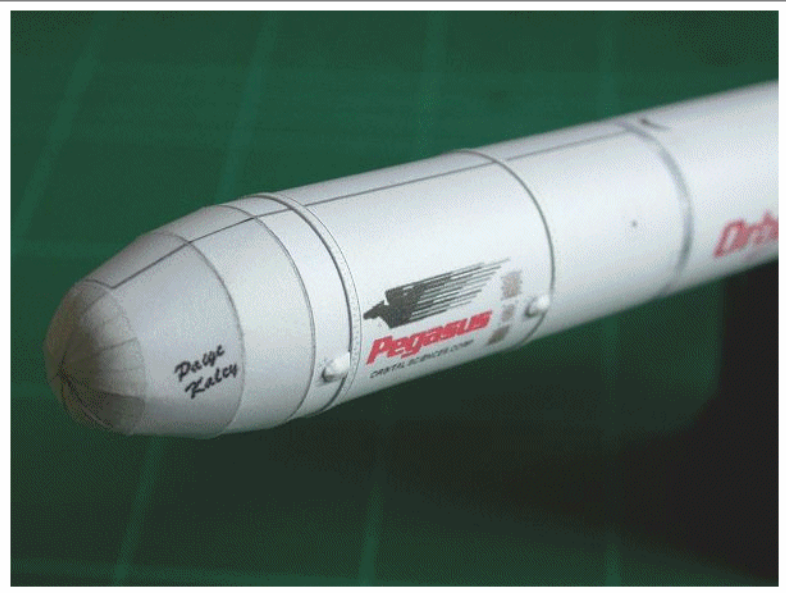
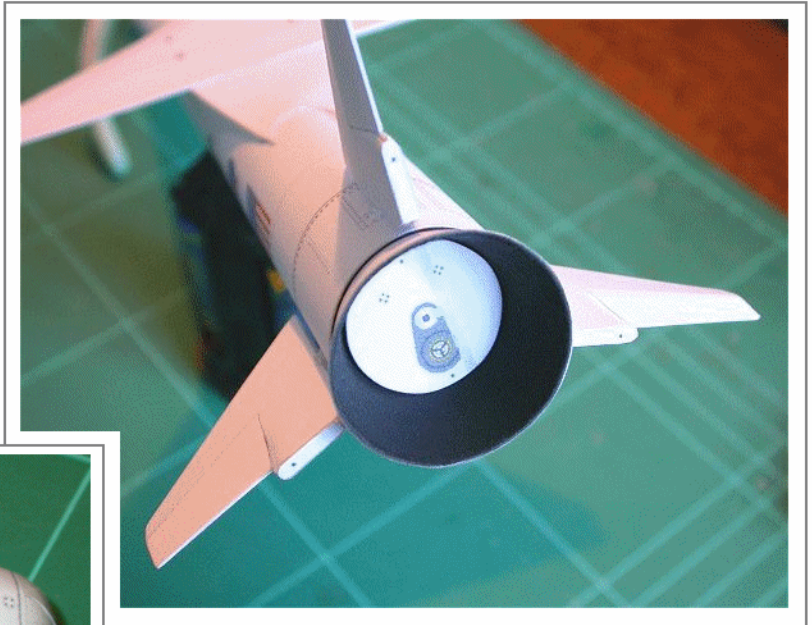
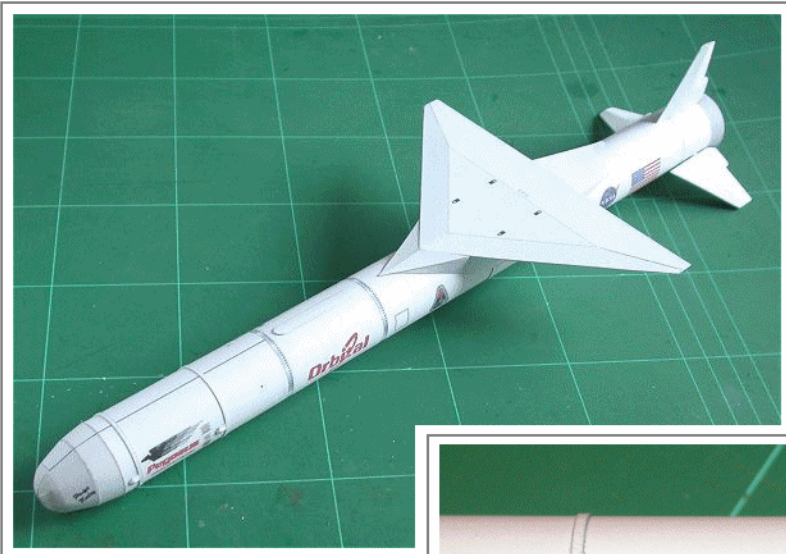



Big Scale 1:48

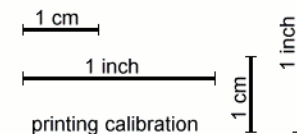
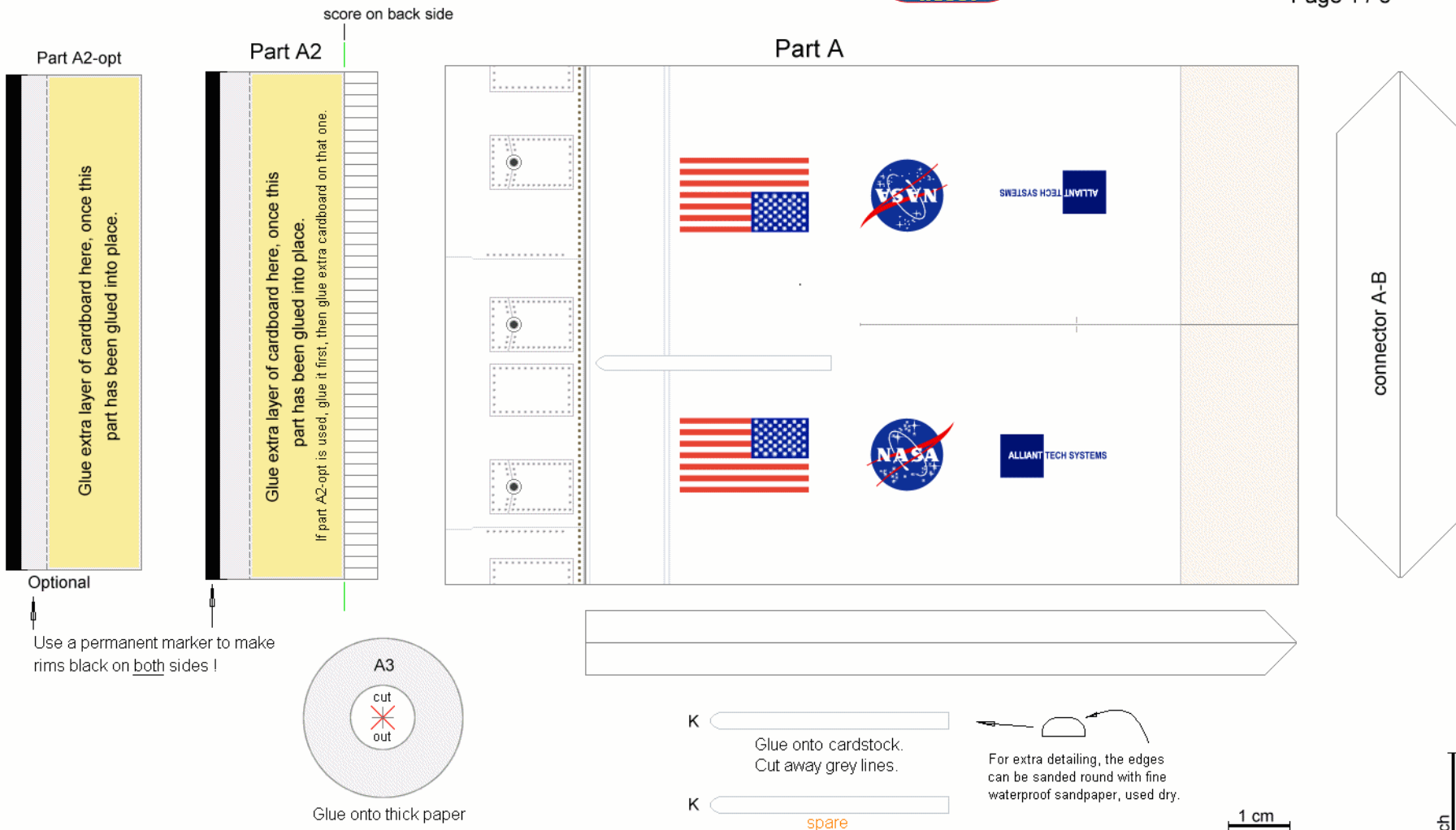
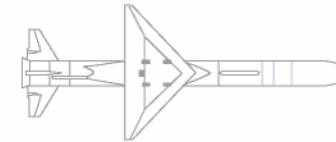



Big Scale 1:48
Superdetailed

Page 2 / 8

Part B

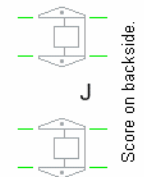
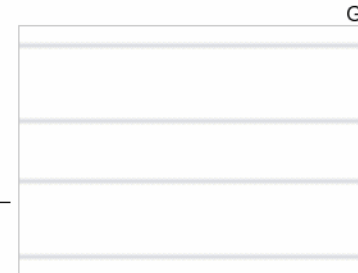
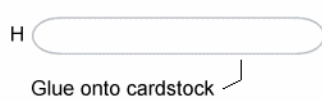
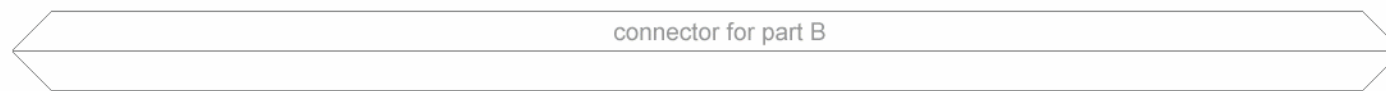
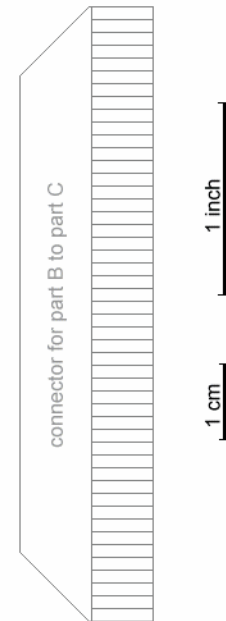
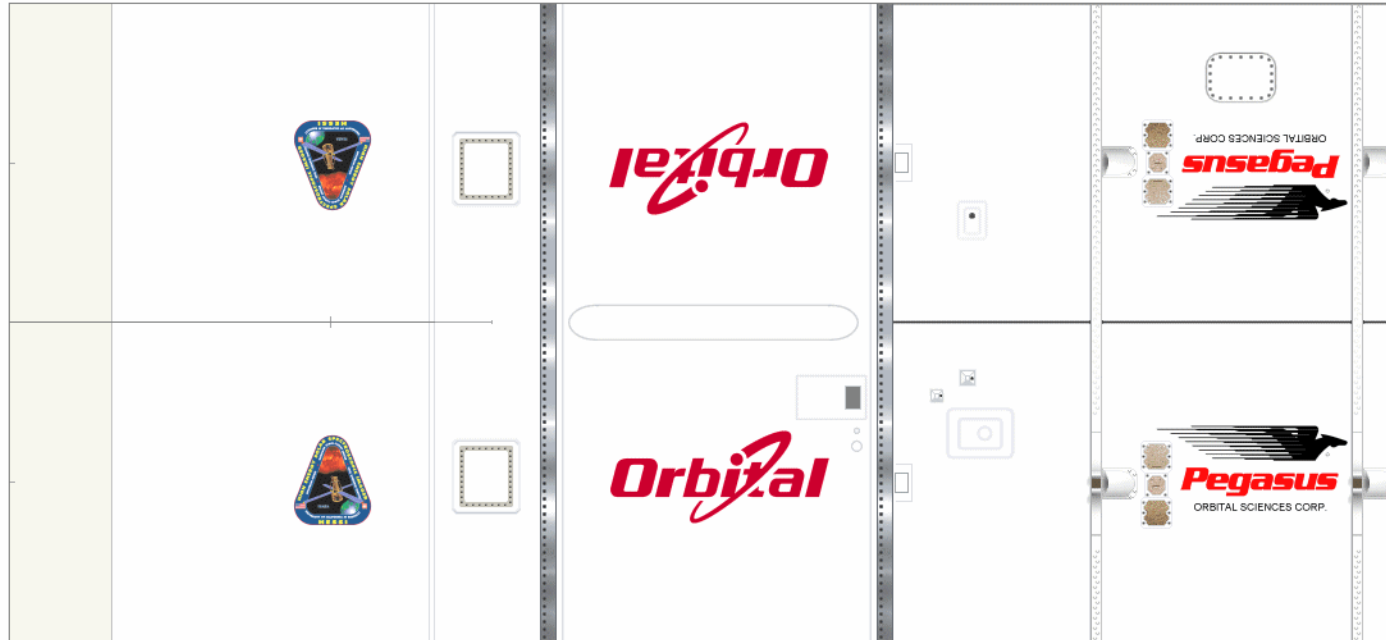

Place part like this.
Stripes are vertical.
First fit dry, cut to size,
then glue into place.

1 cm

1 inch
printing calibration

Paper model version by E. te Groen. For the Public Observatory Philippus Lansbergen, Netherlands.

Do not copy. Not for commercial purposes. For private use only.

www.lansbergen.net

(c) 2004

Optional parts.
Easy assembly.

Do not print Page 4
if you decide to build
this version.



Launcher of the HESSI space telescope.

Big Scale 1:48

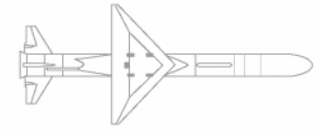

Page 3 / 8

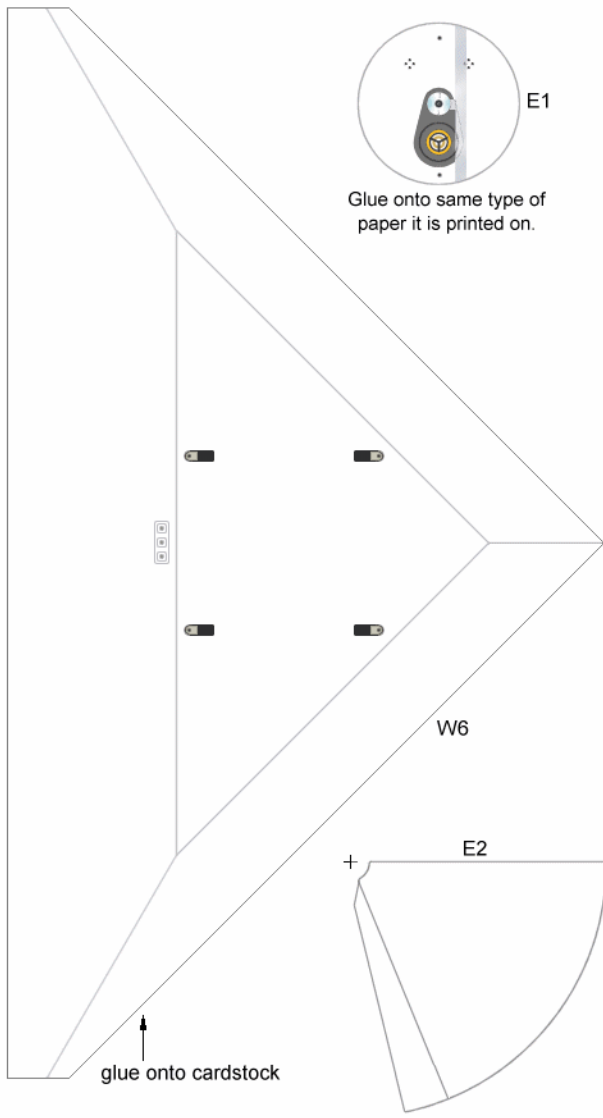
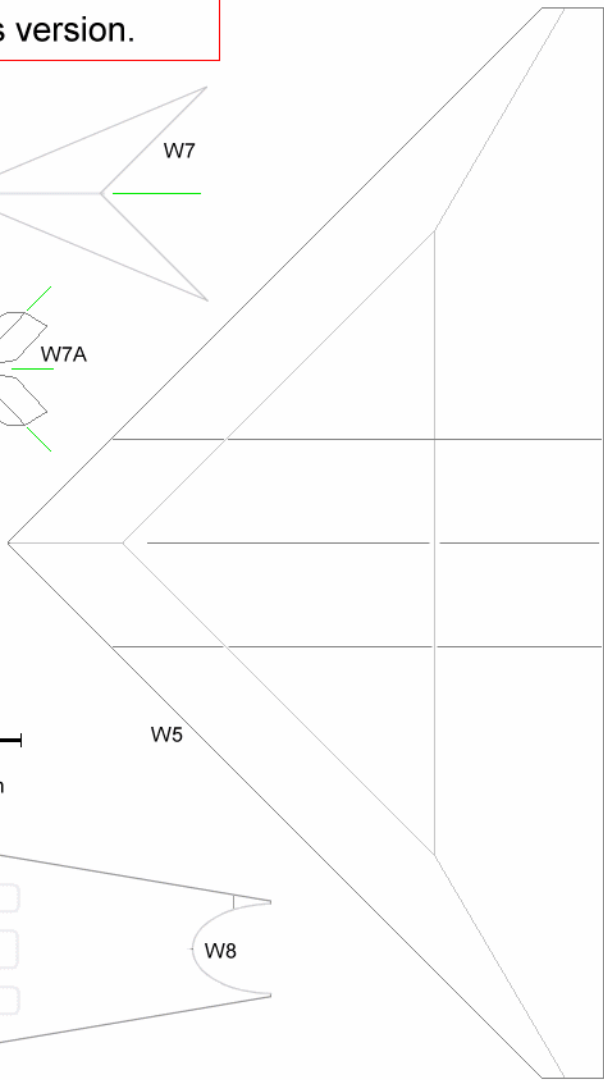
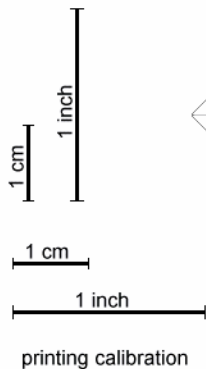
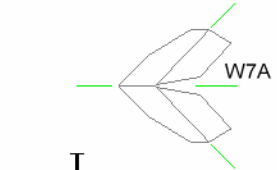
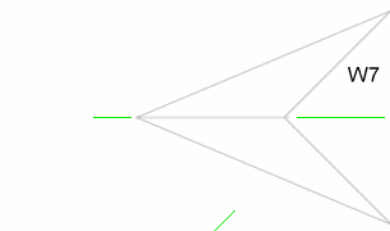

Glue onto same type of paper it is printed on.

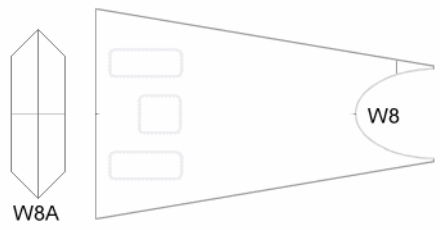
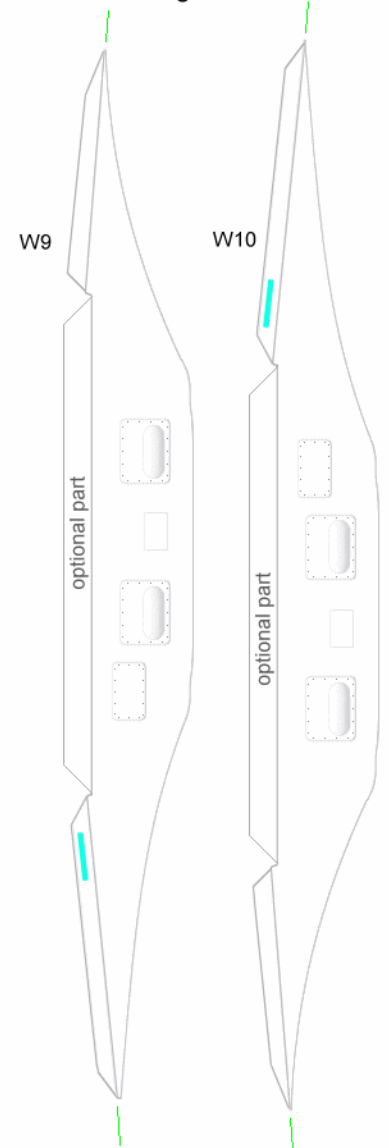

glue onto cardstock

Paper model version by E. te Groen. For the Public Observatory Philippus Lansbergen, Netherlands.

Do not copy. Not for commercial purposes. For private use only.

www.lansbergen.net

(c) 2004



Launcher of the HESSI space telescope.

Big Scale 1:48

Do not print Page 3 if you decide to build this version.

Page 4 / 8

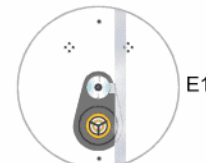

Glue onto same type of paper it is printed on.

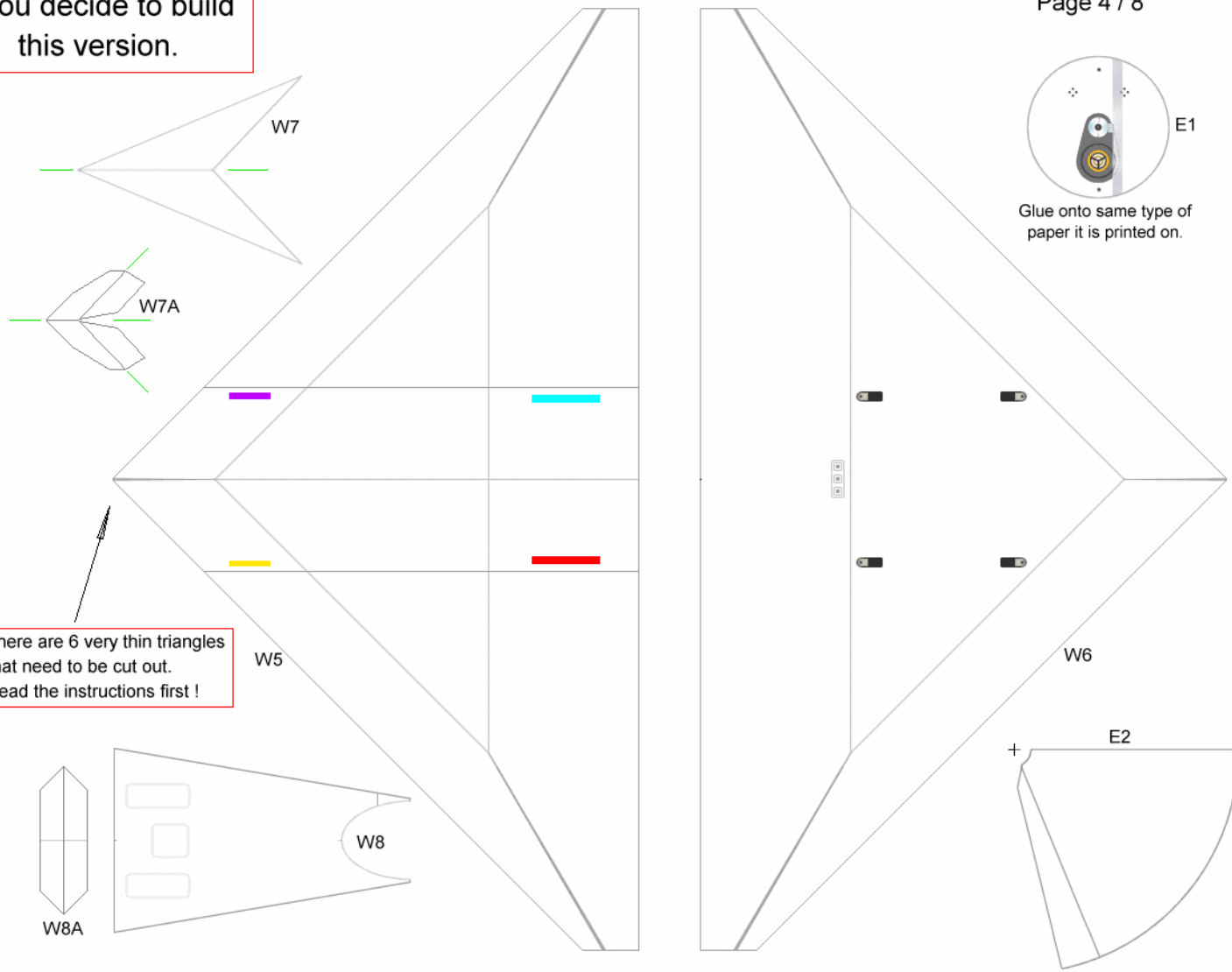

There are 6 very thin triangles that need to be cut out. Read the instructions first !

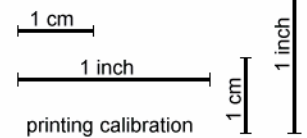
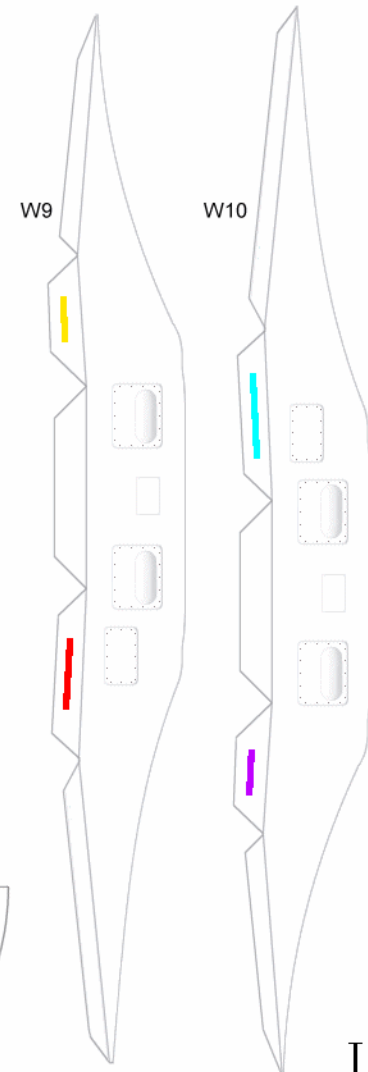

Paper model version by E. te Groen. For the Public Observatory Philippus Lansbergen, Netherlands.

Do not copy. Not for commercial purposes. For private use only.

www.lansbergen.net

(c) 2004



Big Scale 1:48

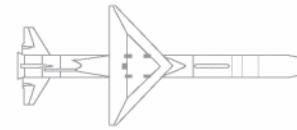

Wing Parts 1, 2, 3 & 4.

Page 5 / 8

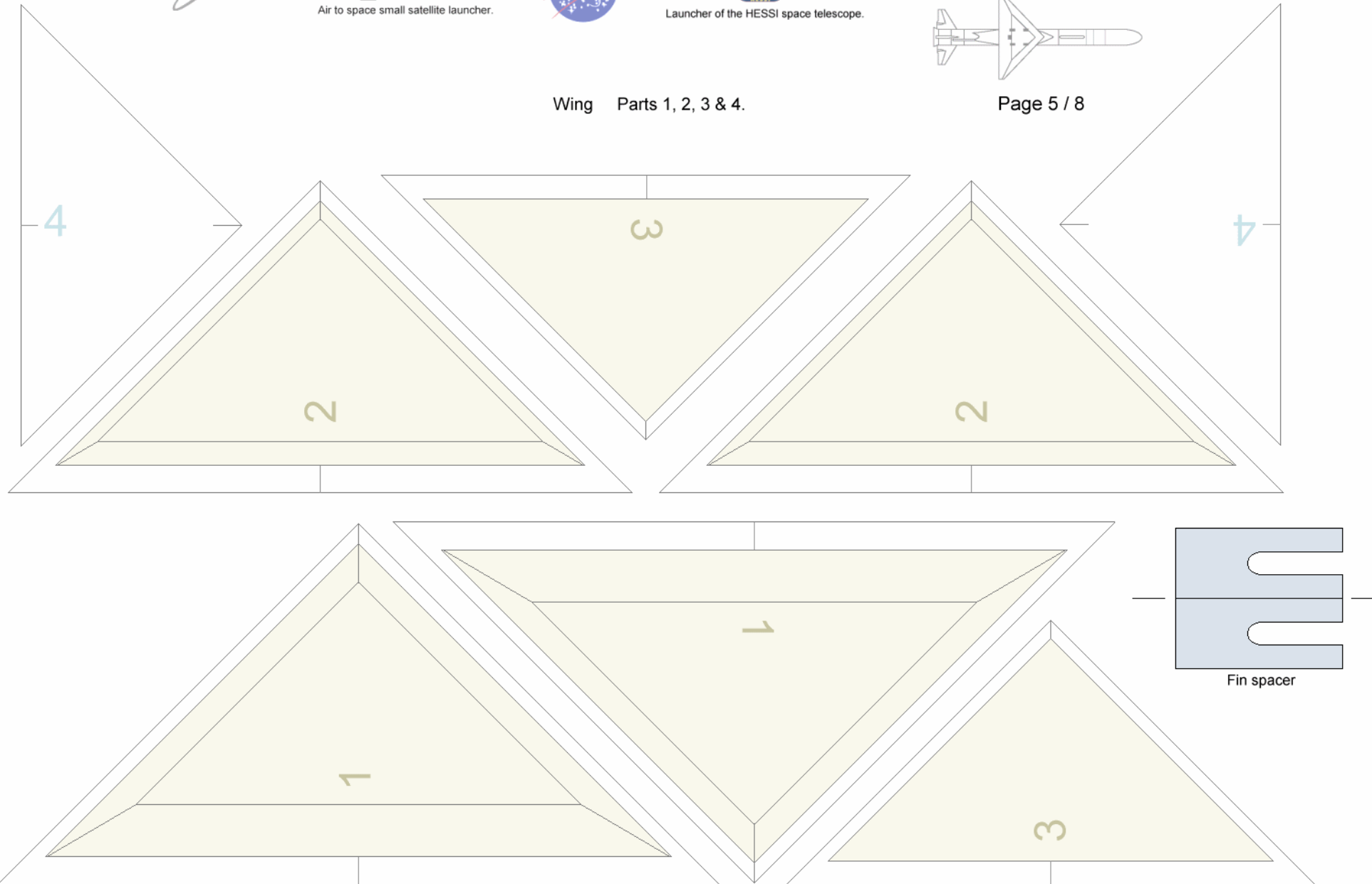

To build the simplified version, only use parts F.

For easy assembly, glue 1 side of Part F to thick cardstock, then cut and glue the other side. Parts M and 1..2 and 3 won't be necessary.

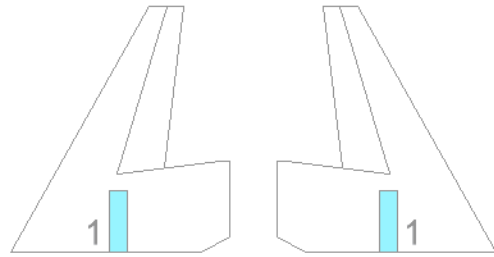
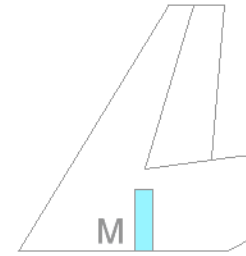
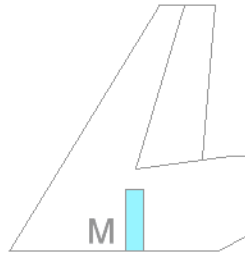
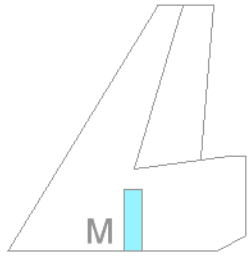
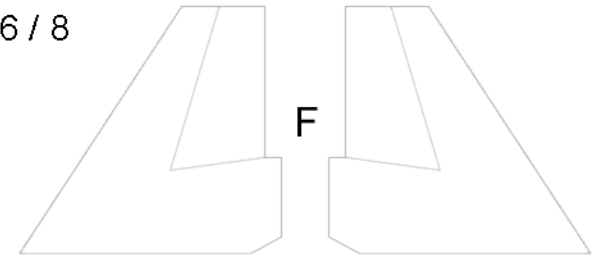
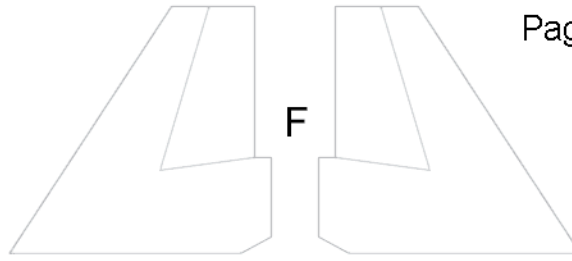
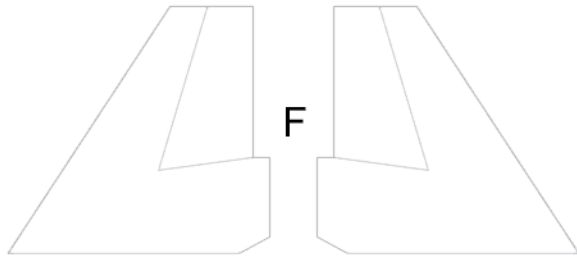

Cut out the blue rectangles.

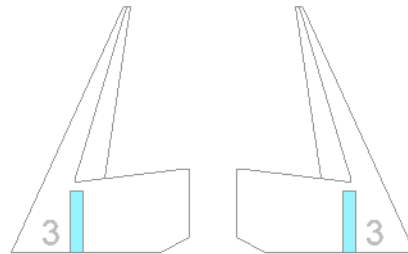
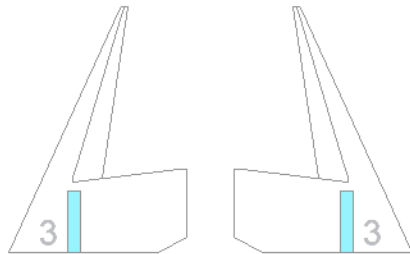
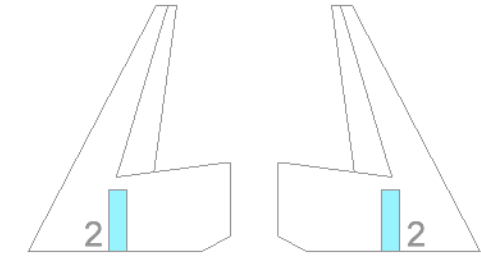
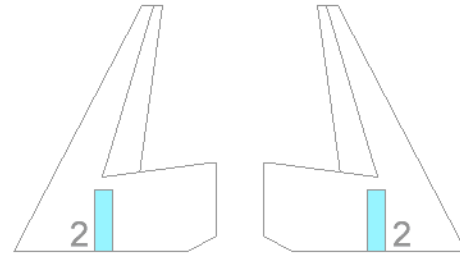
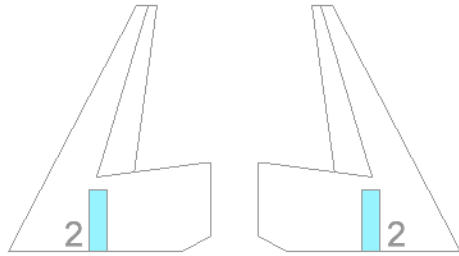
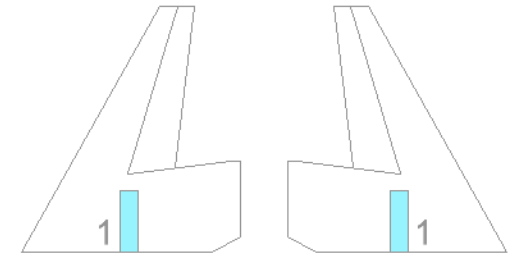
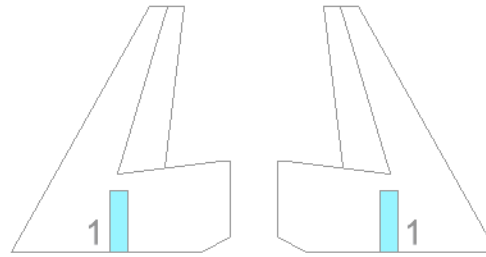

Cut out the blue rectangles.

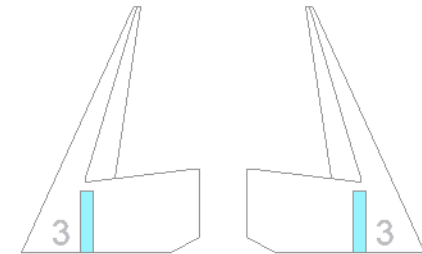

For easy assembly, glue 1 side of Part F to thick cardstock, then cut and glue the other side. Parts M and 1..2 and 3 won't be necessary.

Note : the blue rectangles of parts 3 are slightly narrower than on parts 1 and 2. This is to make a more rounded hole, once assembled.



Launcher of the HESSI space telescope.

Big Scale 1:48

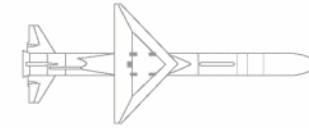

Page 7 / 8

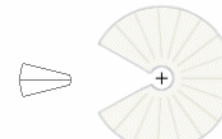
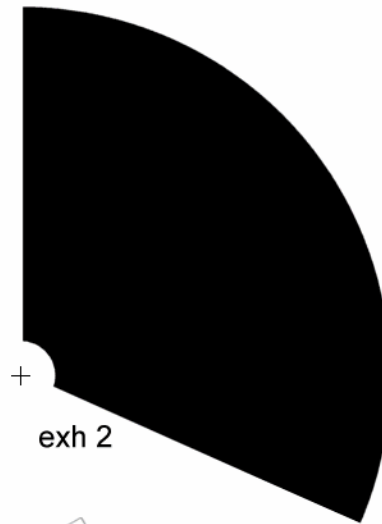
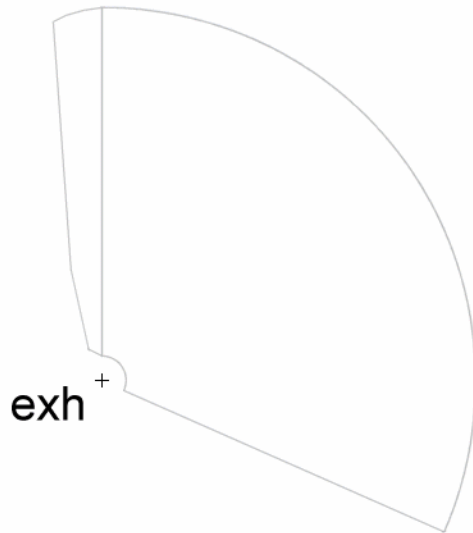

NC 3 A

This one is just slightly bigger than NC 3. See instructions.

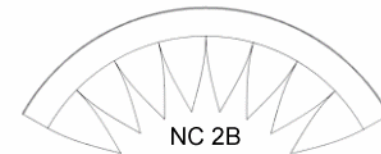

NC 2B

Cut away grey lines around the triangular shapes.

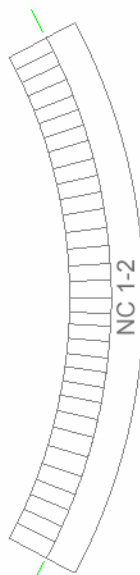
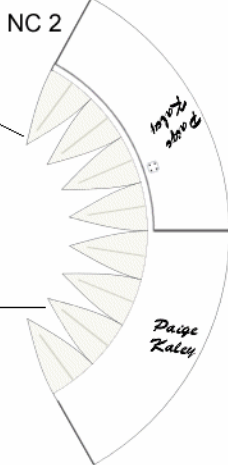

NC 1

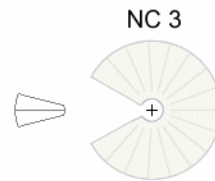

NC 3



NC 2

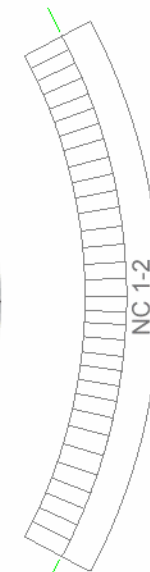
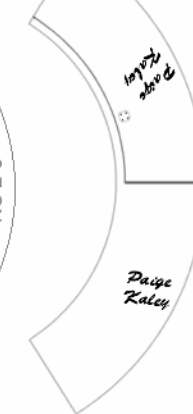

NC 1

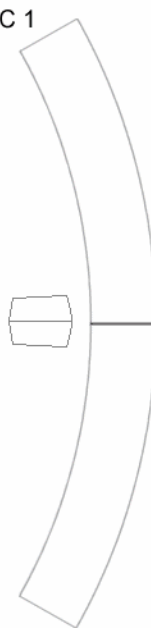

nose cone version 1

nose cone version 2

Paper model version by E. te Groen. For the Public Observatory Philipus Lansbergen, Netherlands.

Do not copy. Not for commercial purposes. For private use only.

www.lansbergen.net

(c) 2004

Special thanks to Ralph Currell for his help on this model.

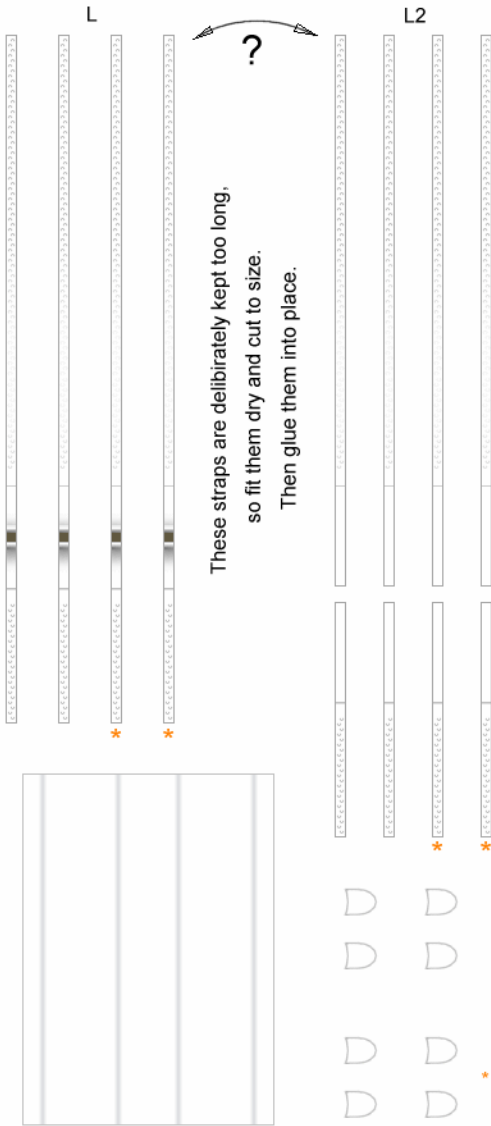

These straps are deliberately kept too long,
so fit them dry and cut to size.
Then glue them into place.

Print this page on medium weight paper.
Print all other pages on thick paper.

These parts are for extra detailing. Choose any part you like.

Examples

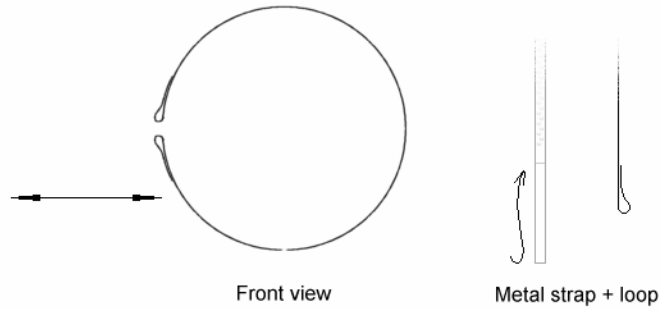

SPARE PARTS

=== Print only when necessary ===

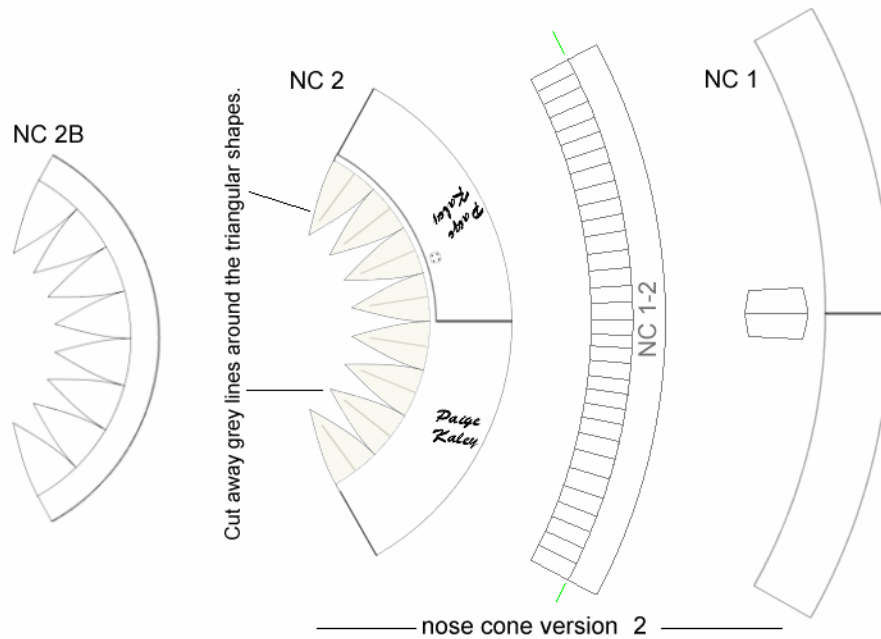
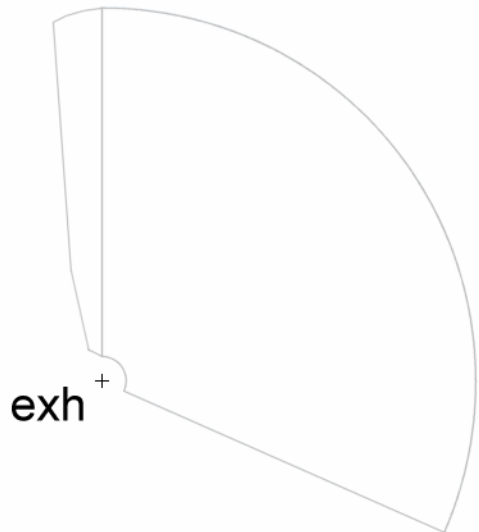
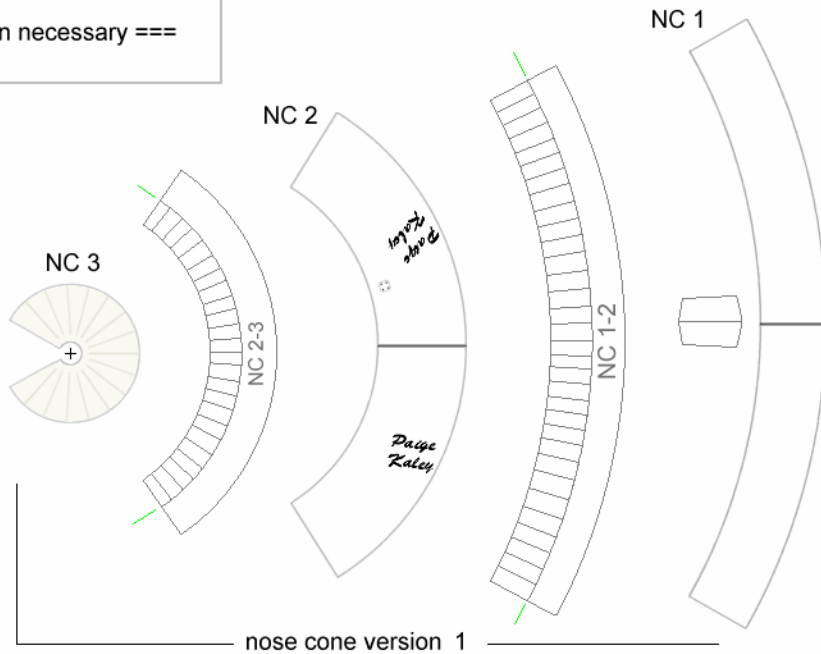
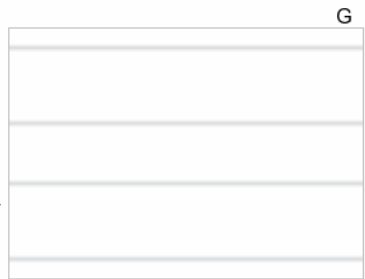

Stand for Pegasus XL paper model.

Print on heavy paper.

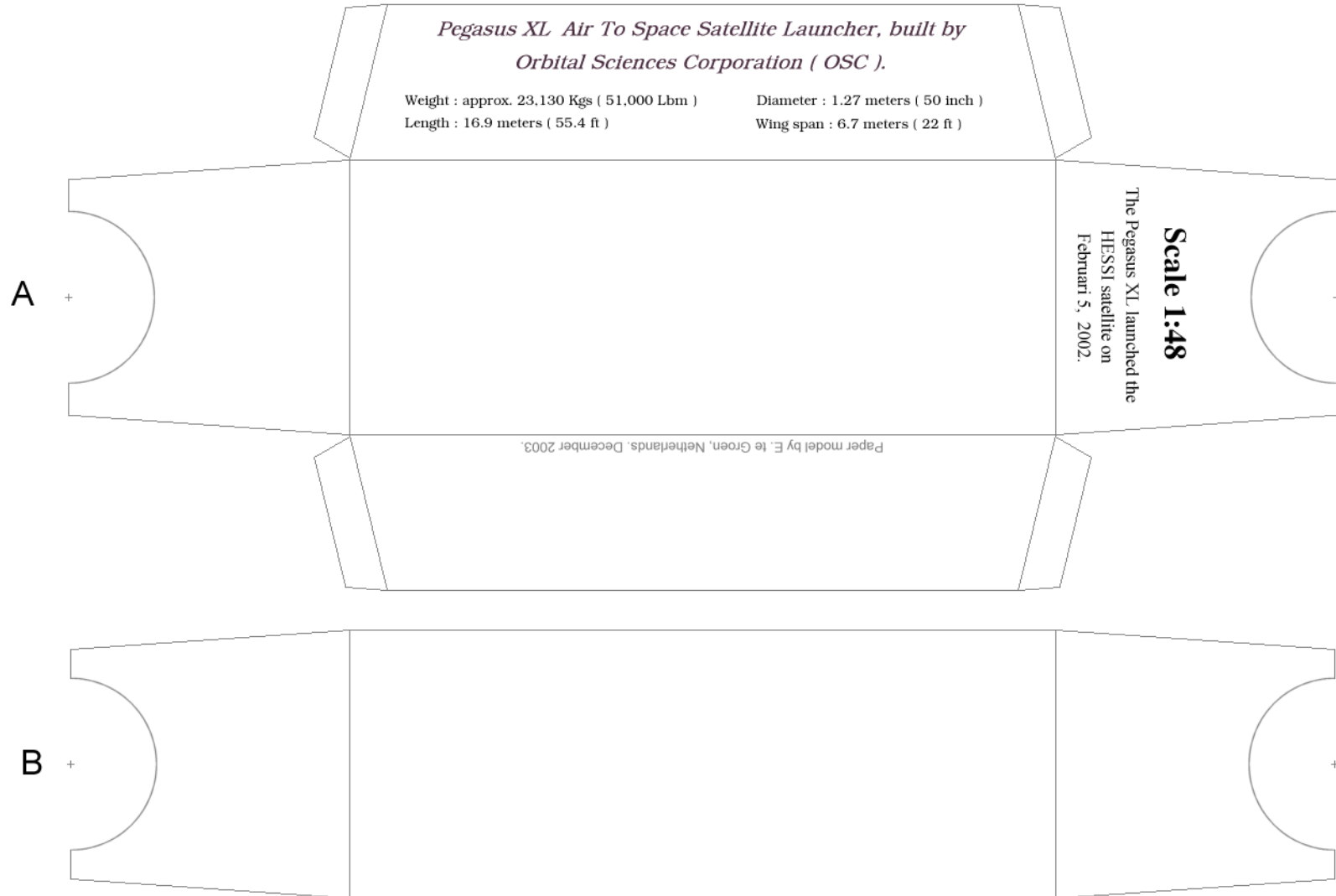

First assemble part A. Then make part B fit and glue it into place, to make part A stronger.